



Touch screen

SATELLITE NAVIGATION SYSTEM

MULTIMEDIA AUDIO SYSTEM

BLUETOOTH TELEPHONE

 The system is protected in such a way that it will only operate in your vehicle.

 For safety reasons, the driver must carry out operations which require prolonged attention while the vehicle is stationary.
When the engine is switched off and to prevent discharging of the battery, the system switches off following the activation of the energy economy mode.

CONTENTS

01	First steps - Control panel	p. 212
02	Steering mounted controls	p. 213
03	General operation	p. 214
04	Navigation: navigation guidance, traffic, map, settings	p. 216
05	Media: photos, radio, music, settings	p. 234
06	Communication: bluetooth, contacts, call log, settings	p. 248
07	Settings: system, vehicle, sound	p. 258
	Frequently asked questions	p. 264

01 FIRST STEPS

Volume adjustment (each source is independent, including TA messages and navigation instructions).

Press to mute the sound.

MODE: selection of the type of permanent display.



To clean the screen, use a soft non-abrasive cloth (spectacles cloth) without any additional product.



Selection of the audio source (depending on version):

- "FM" / "AM" radio wavebands.
- "USB" memory stick.
- CD (located in the glove box)*.
- Telephone connected by Bluetooth and streaming.
- Media player connected to the auxiliary socket (jack, cable not supplied).



Use the zones suggested in the screen using a finger.



Selection of the "MAIN MENU":

- "Navigation" for navigation settings and to select a destination (depending on version).
- "Media" to select radio, MP3 music (from a USB memory stick), view photos.
- "Communications" to connect a telephone by Bluetooth so as to make telephone calls securely or connect to the Internet.
- "Settings" to enter settings for the radio, the vehicle or audio.

Press **MENU** again to quit the "MAIN MENU" and return to the permanent display.

* Depending on equipment.

02 STEERING MOUNTED CONTROLS

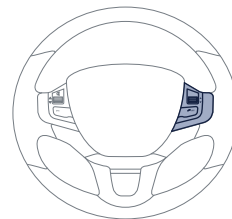
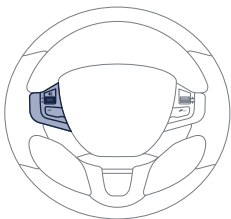

		<ul style="list-style-type: none"> - Press: mute / restore sound.
		<ul style="list-style-type: none"> - Increase volume.
		<ul style="list-style-type: none"> - Decrease volume.
		<ul style="list-style-type: none"> - Press: change the audio source: Radio, Media. - Successive presses: navigation in the menus.

		<ul style="list-style-type: none"> - Rotation. Radio: automatic selection of next / previous frequency. Media: previous / next track. Menus: movement
		<ul style="list-style-type: none"> - Press. Radio: pre-set radio stations. Menus: confirm.
		<ul style="list-style-type: none"> - Incoming call: answer call. - Call in progress: Telephone menu (contacts, call log). End call.
		<ul style="list-style-type: none"> - Radio: display the list of stations. Media: display the list of albums / tracks.

03 GENERAL OPERATION



Press **MODE** several times in succession for access to the following displays:

"Radio"
(or audio source being listened to: CD, USB, Auxiliary)



OR

"Telephone"
(if call in progress)

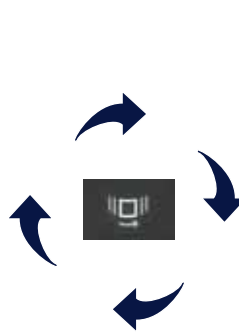

"Trip computer"
(refer to the "Instruments and controls" section)



"Map"
(if navigation guidance in progress)



03 GENERAL OPERATION

Entry keypads (examples)

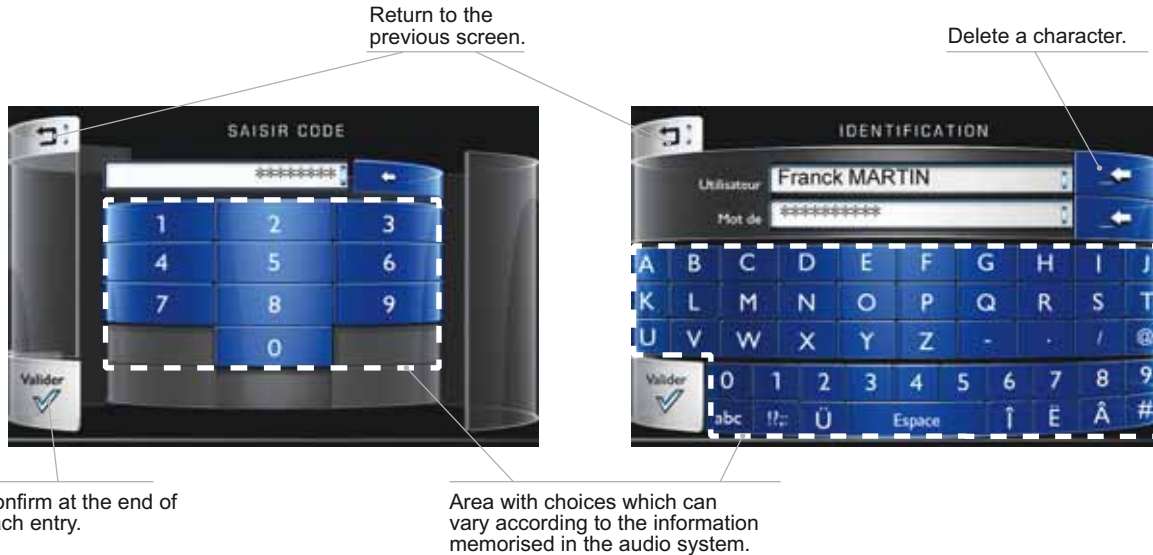

Every time this arrow appears, press the area in question.

04 NAVIGATION

MENU
Press MENU.



Press
"Navigation".

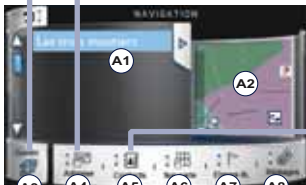

For managing contacts and their addresses, refer to the "Communication" section.

To use the telephone functions, refer to the "Communication" section.



Access to the "Navigation" menu



"Navigation"

- A1 - List of recent destinations. Select an address and press "Calculate route" to start navigation.
- A2 - Press the map to display it full screen.
- A6 - Display the map and zoom to view the routes.
- A7 - Create, add/delete a waypoint or view the itinerary.



On the map



Press an icon for additional information and menu shortcuts.



"Guide"

- A3 - Choose the settings for calculation of the route.
- A31 - Choose the navigation criteria: "Fastest", "Shortest", "Time/Distance compromise", "Include tollroads", "Include ferries", "Pass close to waypoints".
The map displays the route defined in line with the criteria.
- A32 - Display the map and start navigation.

"Address"

- A4 - Enter an address.
- A41 - Enter the country, city, address or the longitude/latitude coordinates.
- A42 - Having chosen an address, press to calculate the route.

"Contacts"

- A5 - Choose an address.
- A51 - Select a contact in the list.
- A52 - Having chosen a contact, press to calculate the route.

"Settings"

- A8 - Set your preferences.
- A81 - Retain the calculation criteria in memory.
- A82 - Detour from your initial route for a certain distance.
- A83 - Activate risk area alerts.
- A84 - Choose the volume for the voice and the announcement of street names.
- A85 - Display the mapping version.

04 NAVIGATION

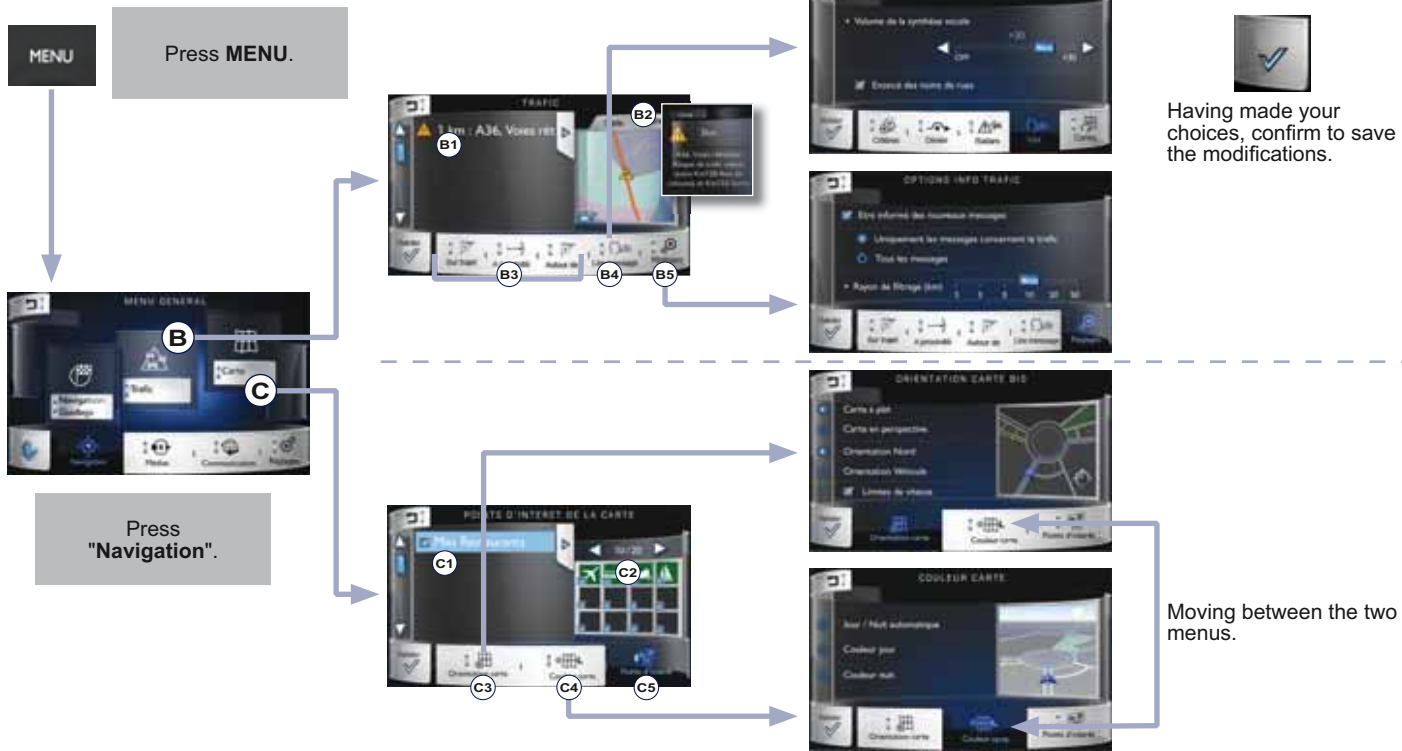



Access to the "Navigation" menu (continued)



"Traffic"

- B1 - List of traffic information messages.
- B2 - Select the map or the descriptive information.
- B3 - Refine the list of traffic information on the route, within a radius of 30 miles (50 km) or at the destination.

"SEARCH FOR POINTS OF INTEREST"

- C1 - List of categories available.
- C2 - Having chosen the category, select the points of interest.

"Audio settings / Voice synthesis"

- B4 - Choose the volume for the voice and for announcing street names.

"TRAFFIC INFORMATION SETTINGS"

- B5 - Set the choice of messages and the radius filter.

"Map heading"

- C3 - Choose the map display in perspective or flat, then North orientation or in the direction of the vehicle (for flat display).

"Map colour"

- C4 - Choose map display in day, night or automatic mode (making use of the vehicle's sunshine sensor).

04 NAVIGATION - GUIDANCE

CHOOSING A DESTINATION

TOWARDS A NEW DESTINATION

1 Press **MENU** to display the "MAIN MENU" then select "Navigation".



2 Select "Navigation GPS".



3 Select "Address".



4 Select the "Country" from the list offered then in the same way: the "City" or its post code, the "Street", the "N°". Confirm each time.



Select "Save" to save the address entered as a contact entry. The system allows up to 200 entries.



5 Select "Guide".



6 Choose the navigation criteria: "Fastest" or the "Shortest" or "Time/Distance compromise". The route is displayed in the map (on the right).



7 Choose the restriction criteria: "Tollroads", "Ferries", "Near".



8 Select "Confirm" or press the screen (blue arrow) to start navigation guidance.



i To delete navigation information, press on "Settings" then "Stop navigation".



To restore the navigation information press on "Settings" then "Restart navigation".



04 NAVIGATION - GUIDANCE

TOWARDS ONE OF THE RECENT DESTINATIONS

1 Press **MENU** to display the "MAIN MENU" then select "**Navigation**".



2 Select "**Navigation GPS**".



3 Select an address from the list offered.

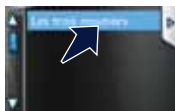

4 Select "**Guide**".
Select the criteria then "**Confirm**" or press the screen (blue arrow) to start guidance.



TOWARDS A CONTACT

i Navigation towards a contact imported from a telephone is only possible if the address entered is compatible with the system.

1 Press **MENU** to display the "MAIN MENU" then select "**Navigation**".



2 Select "**Navigation GPS**".



3 Select "**Contacts**".



4 Select a destination from the contacts in the list offered.

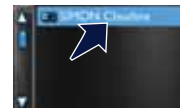

5 Select "**Navigate to**".
Select the criteria then "**Confirm**" to start guidance.



04 NAVIGATION - GUIDANCE

TOWARDS GPS COORDINATES

1 Press **MENU** to display the "MAIN MENU" then select "Navigation".



2 Select "Navigation GPS".



3 Select "Address".



4 Enter the "Longitude" then the "Latitude".



5 Select "Guide".
Select the criteria then "Confirm" or press the screen (blue arrow) to start guidance.



TOWARDS A POINT ON THE MAP

1 Press **MENU** to display the "MAIN MENU" then select "Navigation".



2 Select "Navigation GPS".



3 Select "From map".



4 Zoom in on the map then select the point.



 A long press displays the surrounding tourist attractions.

04 NAVIGATION - GUIDANCE

TOWARDS POINTS OF INTEREST (POI)

Points of Interest (POI) show all of the locations of services nearby (hotels, retail outlet, airports, ...).

1

Press **MENU** to display the "MAIN MENU" then select "Navigation".



2

Select "Navigation GPS".



3

Select "Address".



4

Select "Pts of Interest".



5

Select a category from the list offered (the categories are presented on following pages).



6

Select the points of interest from the list offered.



7a

Select "Search".



or

7b

Select "Along the route" or "Near" or "At a destination" or "At an address" to filter the points of interest.



8

Select a point of interest from the list offered.



9

Select "Guide".
Select the criteria then "Confirm" to start guidance.



04 NAVIGATION - GUIDANCE

LIST OF MAIN POINTS OF INTEREST (POI)

Public transport



Rest areas



Shopping centres



Business centres

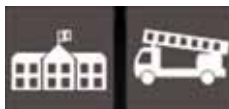

Service stations



Hotels



Restaurants



The detailed procedure for updating POIs can be found at "<http://peugeot.navigation.com>".

04 NAVIGATION - GUIDANCE

RISK AREA ALERT SETTINGS

1

Press **MENU** to display the "MAIN MENU" then select "**Navigation**".



2

Select "**Navigation GPS**".



3

Select "**Settings**".



4

Select "**Risk areas**".



5

It is then possible to activate risk area alerts, then choose:

- "With audible alert"
- "Warnings only when navigating"
- "Alert setting": the choice of timing allows the time before giving a speed camera alert to be defined.

6

Select "**Confirm**".



!

These functions are only available if risk areas have been downloaded and installed on the system.

04 NAVIGATION - GUIDANCE

ADDING A WAYPOINT

- 1 Press **MENU** to display the "**MAIN MENU**" then select "**Navigation**".



- 2 Select "**Navigation GPS**".



- 3 Select "**Waypoints**".



- 4 Select "**Add**".



- 5 Select "**Address**".

- 6 The address of the waypoint is entered in the same way as a destination, so enter the "**City**" or post code, the "**Street**" and the "**N°**". Confirm each time. Then select "**As waypoint**".



- 7 Select "**Guide**".
Select the criteria then "**Confirm**" to start guidance and give the general direction of the navigation route.



ORGANISING WAYPOINTS

- 4 To organise waypoints, carry out the previous operations 1 to 3 again (Adding a waypoint).

- 5 Select the waypoint that you want to move in the order.



- 6a Select "**Up**".



- 6b Select "**Down**".



- 6c Select "**Delete**".



- Select "**Roadmap**" to view the changes made to the route.



04 NAVIGATION - GUIDANCE

ROUTE OPTIONS

CALCULATION CRITERIA

1

Press **MENU** to display the "MAIN MENU" then select "Navigation".



2

Select "Navigation GPS".



3

Select "Settings".



4

Select "Criteria".



5

It is then possible to choose:

- the navigation criteria: "**Fastest**", "**Shortest**", "**Time/Distance compromise**",
- the exclusion criteria: "**Include tollroads**", "**Include ferries**", "**Pass close to waypoints**", "**Take traffic into account**".

6

Select "Confirm".



04 TRAFFIC

TRAFFIC INFORMATION

DISPLAY OF MESSAGES

1 Press **MENU** to display the "MAIN MENU" then select "Navigation".



2 Select "Traffic".



3 Set the "Along the route", "Near", "Around" filters to fine-tune the list.
Press again to remove the filter.



4 Select the message from the list offered.
Select "Map" or "Details" for more information.

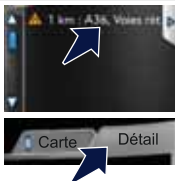

i TMC (Traffic Message Channel) messages contain information on traffic and weather conditions, received in real time and transmitted to the driver in the form of audible announcements and symbols on the navigation map.

SETTING FILTERS

1 Press **MENU** to display the "MAIN MENU" then select "Navigation".
Select "Traffic".



2 Select "Settings".



3 Select:
- "Warn of new messages",
- "Traffic messages only",
- "All messages".
Then enter the filter radius.



4 Select "Confirm".



i We recommend a filter radius of:
- 12 miles (20 km) in urban areas,
- 30 miles (50 km) on motorways.

04 TRAFFIC

MAIN TRAFFIC SYMBOLS

1 Red and yellow triangle: traffic information, for example:



2 Black and blue triangle: general information, for example:



RECEIVING TA MESSAGES

1 Press the **MODE** until the "RADIO" display is obtained.



2 Select "TA".



3 Select "Traffic announcements (TA)".



4 Select "Confirm".



i The TA (Traffic Announcement) function gives priority to TA alert messages. To operate, this function needs good reception of a radio station transmitting this type of message. When a traffic report is transmitted, the current audio source (Radio, CD, USB, ...) is interrupted automatically to play the TA message. Normal playback of the audio source resumes at the end of the transmission of the message.

04 TRAFFIC

DIVERSION FROM A ROUTE

1 Press from **MENU** to display the "**MAIN MENU**" then select "**Navigation**".



2 Select "**Navigation GPS**".



3 Select "**Settings**".



4 Select "**Diversion**".



5 Select the diversion distance by pressing + or -.



6 Select "**Recalculate route**". The route will be modified in time and distance.



7 Select "**Confirm**".



 The route may be diverted following the reception of a traffic information message.

04 MAP

MAP MANAGEMENT

SELECTING THE POINTS OF INTEREST DISPLAYED ON THE MAP

1

Press **MENU** to display the "MAIN MENU" then select "Navigation".



2

Select "Map".



3

Select "Points of Interest".



4

Select a category from the list offered (the categories are given on previous pages).

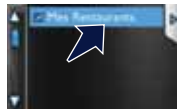

5

Select the points of interest from the list for them to be displayed in the screen.



6

Select "Confirm".



04 MAP

MAP ORIENTATION

- 1 Press **MENU** to display the **"MAIN MENU"** then select **"Navigation"**.



- 2 Select **"Map"**.



- 3 Select **"Map heading"**.



- 4 Select:
- **"Flat map view"** to display the map in 2D,
 - **"Perspective map view"** to display a perspective view.
- With **"Flat map view"**:
- **"North heading"** to keep the map always North up,
 - **"Vehicle heading"** to have the map follow the direction of travel.
- Then **"Confirm"** to save the modifications.



MAP COLOUR

- 1 Press **MENU** to display the **"MAIN MENU"** then select **"Navigation"**.



- 2 Select **"Map"**.



- 3 Select **"Map colour"**.



- 4 Select:
- **"Automatic day/night mode"** to have the brightness of the map adjusted automatically according to the ambient light level, using the vehicle's sunshine sensor,
 - **"Map in daytime mode"** to have the map always in day mode,
 - **"Map in night time mode"** to have the map always in night mode.
- Then **"Confirm"** to save the modifications.



Street names are visible on the map from the 100 m scale.

04 SETTINGS

NAVIGATION SPEECH SYNTHESIS

VOLUME / STREET NAMES

1

Press **MENU** to display the "**MAIN MENU**" then select "**Settings**".



2

Select "**Audio**".



3

Select "**Voice**".



4

Adjust "**Voice synthesiser volume**" and/or "**State street names**" (spoken during navigation guidance).

5

Select "**Confirm**".



05 MEDIA

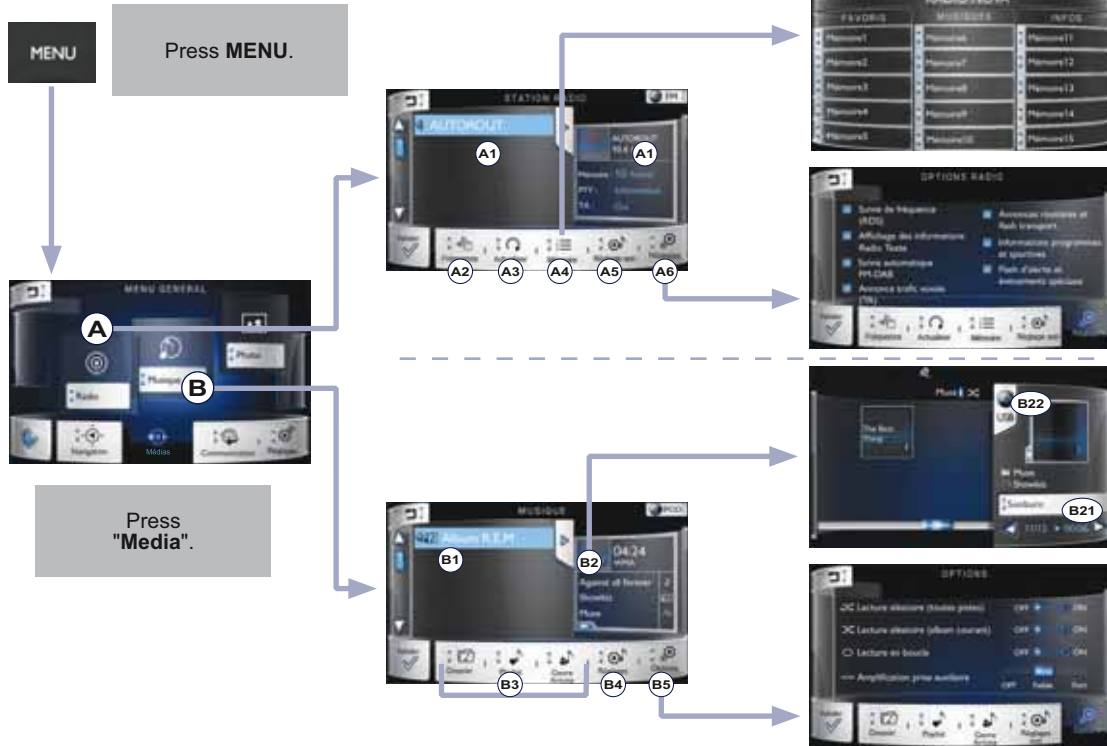

After making your choices, confirm to save the modifications.



Access to the "Media" menu

"Radio"

- A1 - List of radio stations available and description of the station selected. Press twice to receive the radio station.
- A2 - Enter the frequency of the radio station desired.
- A3 - Update the list with the stations currently received.

- A5 - Adjust the sound distribution in the vehicle, audio ambiances, sound effects, voice synthesis, telephone ringtones.

"Music"

- B1 - List of folders or files available.

- B3 - Classified by folder, playlist or genre-artist. Press twice on the folder to go down a level. Press ▲ or the back button to go up a level.
- B4 - Adjust the sound distribution in the vehicle, audio ambiances, sound effects, voice synthesis, telephone ringtones.

"Memory"

- A4 - List of pre-set (memorised) radio stations. Press a radio station to select it.

"Settings"

- A6 - Activate traffic announcements (TA), alternative frequencies (RDS), radio text, travel information, general information, programme information, alert flashes.

"Album selection"

- B2 - Choose an album using the sleeve displayed.
- B21 - Press twice on the sleeve to display the list of albums in text format.
Select files using the ◀ or ▶ arrow.
- B22 - Press to change the source (CD, USB, auxiliary).

"Play options"

- B5 - Set random or repeat play.
Amplify the auxiliary source to increase the sound level.

05 MEDIA

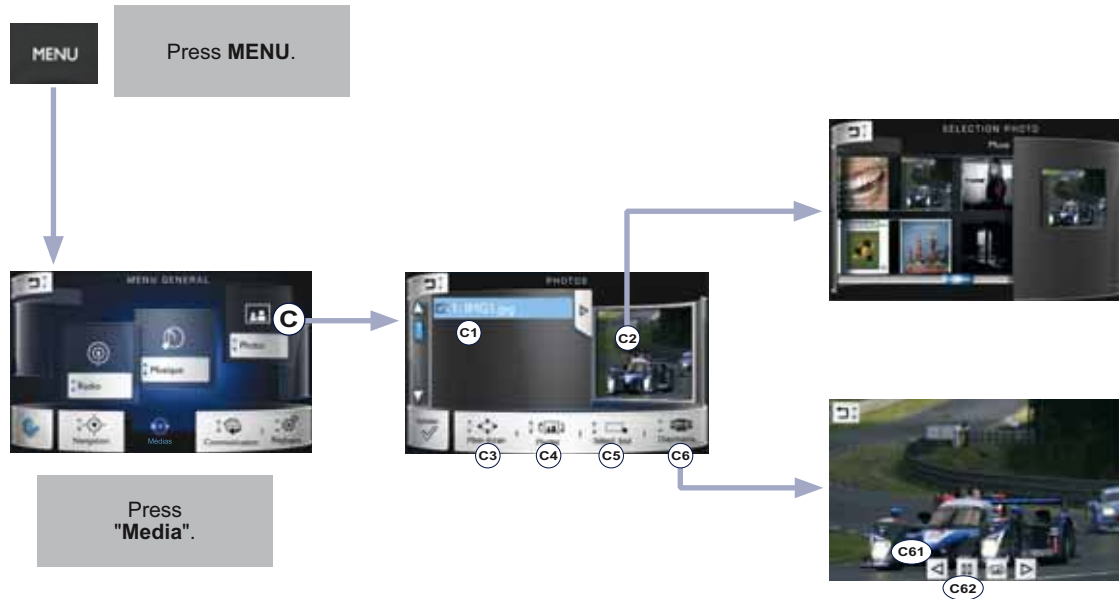



Access to the "Media" menu (continued)

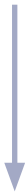

"Photo"

- C1 - List of photographs available on a USB memory stick (not supplied, 2 GB maximum).
- C3 - Display the selected photo full screen.
- C4 - Rotate the photo 90°.
- C5 - Select all the photos in the list.
Press again to deselect them.

"Photo selection"

- C2 - Choose a photo from a preview.

"Slideshow"

- C6 - Display the photos in succession in full screen.
- C61 - Press ◀ or ▶ to choose the previous or next photo.
- C62 - Press pause/play to stop/start the slideshow.

05 RADIO

SELECTING A STATION

OR

1a

Press **MENU** to display the "MAIN MENU" then select "Media".



2a

Select "Radio".



3a

Select a radio station from the list offered.



Select "Update" to refresh the list.



1b

Press the **MODE** button until the **RADIO** is displayed.



2b

If necessary, select changing the source.



3b

Select "FM Radio" or "AM Radio".



The exterior environment (hills, buildings, tunnel, car park, below ground...) may prevent reception, even in RDS station tracking mode. This phenomenon is normal in the propagation of radio waves and is in no way indicative of a fault with the audio system.

05 RADIO

CHANGE A RADIO FREQUENCY

OR

1a

Press **MENU** to display the "MAIN MENU" then select "Media".



1b

Select changing source.



2a

Select "Radio".



2b

Select "FM Radio" or "AM Radio".



3a

By manual frequency search



Press "Frequency", then enter the frequency using the keypad and confirm.



3b

By alphabetical list

Press the current radio band then choose the radio station from the list offered.



3c

By automatic frequency search

Press ◀ or ▶ to move the cursor for an automatic search down or up for a radio frequency.

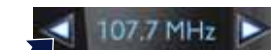

05 RADIO

PRESET A STATION

1 Select a radio station or frequency
(refer to the corresponding section).

2 From the permanent display, press **"Memory"**.



3 Select a number in the list to preset the
previously chosen radio station.
A long press on this number presets the station.



Recall pre-set stations

Press **MENU** to display the **"MAIN MENU"** then
select **"Media"**.



Select **"Radio"**.



Select **"Memory"**.



05 RADIO

ACTIVATE / DEACTIVATE RDS

1

Press the **MODE** button until the **RADIO / MEDIA** display is obtained.



2

Select **"RDS"**.



3

Select **Alternative frequencies (RDS)**.



4

Select **Confirm**.



i

RDS, if activated, allows you to continue listening to the same station by automatic retuning to alternative frequencies. However, in certain conditions, coverage of an RDS station may not be assured throughout the entire country as radio stations do not cover 100 % of the territory. This explains the loss of reception of the station during a journey.

05 MUSIC

CD, MP3 CD, USB PLAYER, AUXILIARY



Insert the CD in the player, insert the USB memory stick in the USB player or connect the USB peripheral to the USB port using a suitable cable (not supplied).

The system builds playlists (in temporary memory), an operation which can take from a few seconds to several minutes at the first connection.

Reduce the number of non-music files and the number of folders to reduce the waiting time.

The playlists are updated every time the ignition is switched off or connection of a USB memory stick. However, the system memorises these lists and if they are not modified, the loading time will be shorter.

Play starts automatically after a period which depends on the capacity of the USB memory stick.



SELECTION OF SOURCE

- 1 Press the **MODE** button until the **RADIO / MEDIA** display is obtained.
- 2 Select changing source then choose the source.



It is also possible to change source from the top bar.



The steering mounted **SRC** (source) button can be used to go to the next media source, available if the source is active.

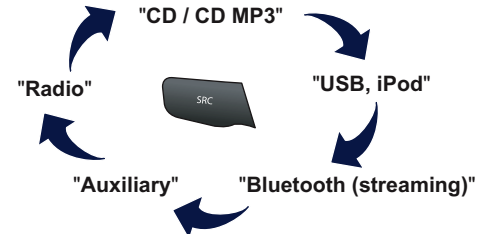

05 MUSIC

CD, MP3 CD / USB PLAYER

INFORMATION AND ADVICE



The audio equipment will only play audio files with ".wma, .aac, .flac, .ogg and .mp3" file extensions and with a bit rate of between 32 Kbps and 320 Kbps.

It also supports VBR (Variable Bit Rate) mode.

No other type of file (.mp4, .m3u...) can be played.

WMA files must be of the standard wma 9 type.

The sampling rates supported are 11, 22, 44 and 48 KHz.



It is advisable to restrict file names to 20 characters, without using of special characters (e.g.: " " ? ; ù) to avoid any playing and displaying problems.



In order to be able to play a recorded CDR or CDRW, when recording it is preferable to select the ISO 9660 level 1, 2 or Joliet standard.

If the disc is recorded in another format it may not be played correctly.

It is recommended that the same recording standard is always used for an individual disc, with as low a speed as possible (4x maximum) for optimum sound quality.

In the particular case of a multi-session CD, the Joliet standard is recommended.



The system supports USB mass storage or iPod devices via the USB port (suitable cable not supplied).

Control of the peripheral device is with the audio system controls.

Other peripherals, not recognised on connection, must be connected to the auxiliary socket using a Jack cable (not supplied).

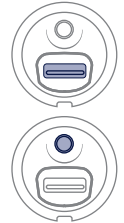

In order to be read, a USB memory stick must be formatted FAT 16 or 32.







The system does not support the operation of an Apple® and a USB memory stick connected at the same time.







It is recommended that official Apple® USB cables are used to ensure correct operation.

05 MUSIC

SELECTING A TRACK

Previous track.	
Next track.	
Previous folder.	
Next folder.	
Pause.	

List of USB or CD tracks and folders.	
Up or down in the list.	
Confirm, next menu level.	
Up one menu level.	

05 MUSIC

CONNECTING APPLE® PLAYERS

1

Connect the Apple® player to the USB port using a suitable cable (not supplied).
Play starts automatically.



2

Control is via the audio system.

i

The classifications available are those of the portable device connected (artists / albums / genres / playlists / audiobooks / podcasts).
The default classification used is by artist. To modify the classification used, return to the first level of the menu then select the desired classification (playlists for example) and confirm to go down through the menu to the desired track.

i

Copies of photos and album artwork are not compatibles with the audio system. These appear only with a USB memory stick.

!

The version of software in the audio system may not be compatible with the generation of your Apple® player.
The list of devices compatible with software versions is available from PEUGEOT dealers.

AUDIO STREAMING



Streaming allows audio files on your telephone to be played via the vehicle's speakers.

1

Connect the telephone: see "Communication", "Bluetooth" section.
Choose the "**Audio**" or "**All**" profile.

2

If play does not start automatically, it may be necessary to start the audio playback from the telephone.
Control is from the peripheral device or by using the audio system buttons.

!

Once connected in streaming mode, the telephone is considered to be a media source.
It is recommended that you activate "**Repeat**" on the Bluetooth peripheral.

05 MUSIC

USING THE AUXILIARY INPUT (AUX) Cable not supplied

- 1** Connect the portable device (MP3 player...) to the auxiliary JACK socket using an audio cable.



- 2** Press the **MODE** button until the **RADIO** display is obtained.



- 3** Select changing the source.



- 4** Select the **AUXILIARY** source.



- i** First adjust the volume of your portable device (to a high level). Then adjust the volume of your audio system. Display and management of the controls are via the portable device.

05 SETTINGS

AUDIO

1

Press **MENU** to display the "MAIN MENU", then select "**Settings**".



2

Select "**Audio**".



3

Select "**Ambience**" or "**Distribution**".



!

The distribution (or spatialisation using the Arkamys® system) of sound is an audio process that allows the audio quality to be adapted to the number of listeners in the vehicle.

!

The audio settings (**Ambience**, **Bass**, **Treble** and **Loudness**) are different and independent for each sound source.
The settings for distribution and balance are common to all sources.

!

- "**Ambience**" (choice of 6 musical ambiances)
- "**Bass**"
- "**Treble**"
- "**Loudness**" (Activate/Deactivate)
- "**Distribution**" ("**Driver**", "**All passengers**", "**Front speakers only**")

i

On-board Audio: Arkamys® Sound Staging.

With Sound Staging, the driver and passengers are immersed in an "audio scene" recreating the natural atmosphere of an auditorium: truly a part of the scene and its surroundings.

This new sensation is made possible by software in the audio system which processes the digital signals from the media players (radio, CD, MP3...) without changing the audio settings. This processing takes account of the characteristics of the passenger compartment to produce optimum results.

The Arkamys® software installed in your audio system processes the digital signal from the media players (radio, CD, MP3, ...) and recreates a natural musical scene, with harmonious placement of instruments and voices in the space in front of passengers, level with the windscreen.

06 COMMUNICATION

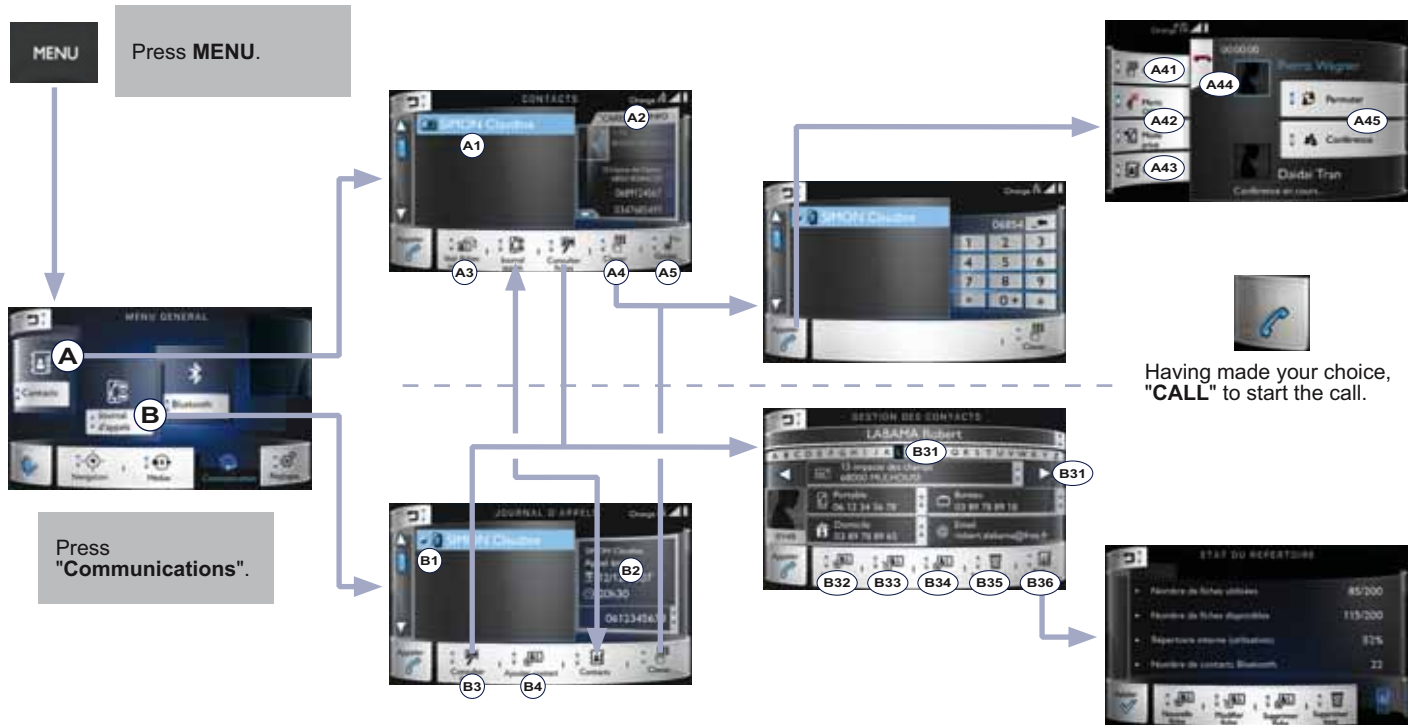



Access to the "Communications" menu

"Contacts"

- A1 - List of contacts saved in the telephone.
Press twice to start the call.
- A2 - Select information on the contact or the position of the contact on the map, using their address.
When the information is displayed, press a number to start the call or the address to start navigation.
- A3 - Display the list of contacts saved in the vehicle.
- A5 - Press to start navigation towards the selected contact, using their address.

"Call log"

- B1 - List of outgoing, missed and incoming calls.
- B2 - Details of the call selected.
Press the number to start the call.
- B4 - Add a new contact.

"Keypad"

- A4 - Enter a number using the keypad.
Press **CALL** to start the call.
- A41 - Enter another number.
- A42 - "Micro OFF": cut the microphone temporarily so that the contact does not hear your conversation with a passenger.
- "Privacy mode": transfer to your telephone for a private conversation or to leave the vehicle without ending the call.
- A43 - Choose another contact in the list.
- A44 - End the call in progress.
- A45 - "Switch call": change contact while retaining the current contact.
- "Conference call": accept the incoming call and communicate with more than one person.

"Contacts"

- B3 - Manage the contact entries saved:
- B31 - Use the alphabet or the arrows to find a contact by their name.
- B32 - Create a new contact.
- B33 - Modify the displayed contact.
- B34 - Delete the displayed contact.
- B35 - Delete all the information for the displayed contact.
- B36 - Contact folder info: entries used or available, percentage of internal directory used and Bluetooth contacts.

06 COMMUNICATION

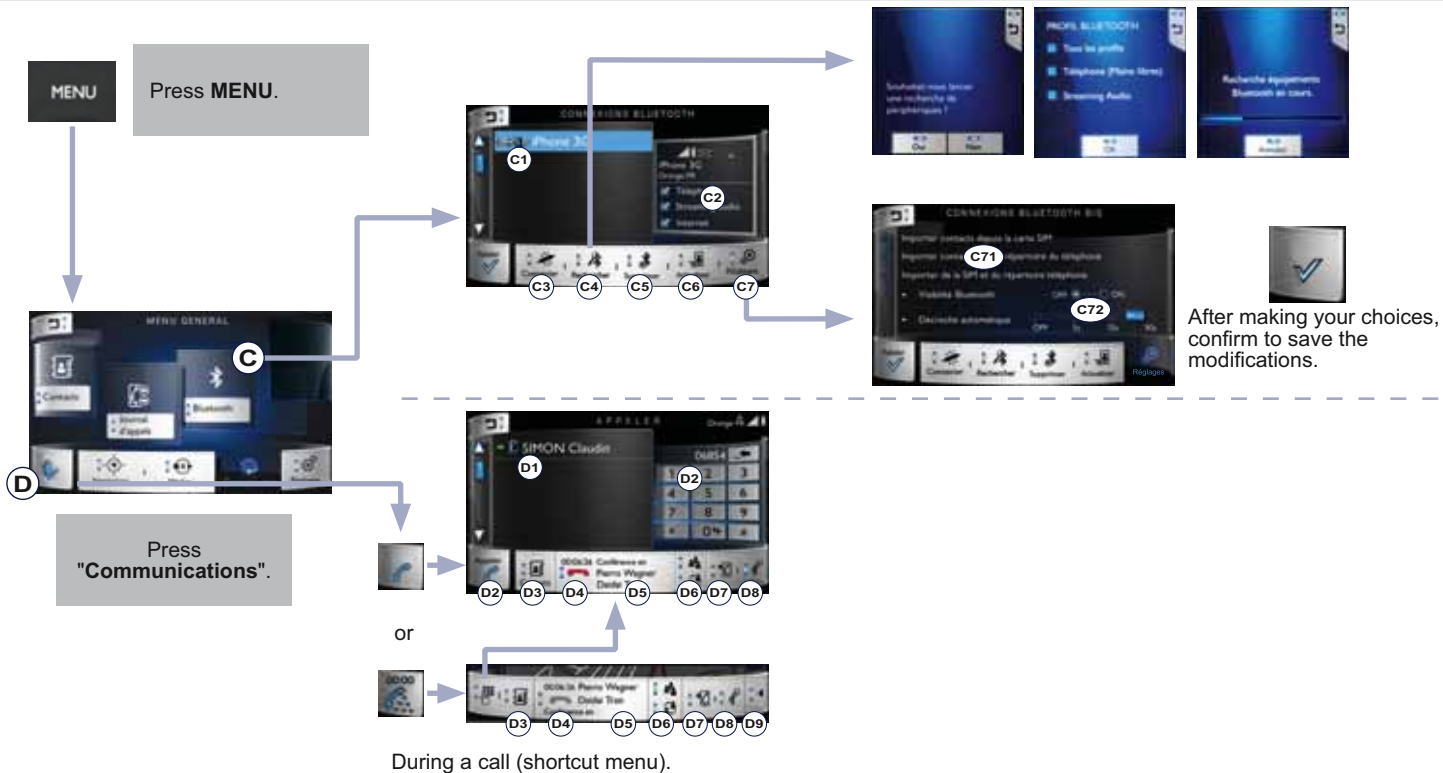



Access to the "Communications" menu (continued)

"Bluetooth"

- C1 - List of telephones already paired with the audio system.
- C2 - Display a description of the telephone.
- C3 - Connect/disconnect the selected telephone.

- C5 - Delete the selected telephone.
- C6 - Import the contacts from the selected telephone to store them in the audio system.

"Search"

- C4 - Start the search for another peripheral so as to connect it to the audio system via Bluetooth.

"Settings"

- C7 - Your Bluetooth settings.
- C71 - Import contacts from the telephone to the audio system.
- C72 - Make the audio system (telephone, ...) visible externally via Bluetooth.
Setting the answering time for an incoming call.

"CALL" (shortcut menu)

- D1 - List of outgoing, missed and incoming calls.
- D2 - Enter an number using the keypad.
Then press "CALL" to start the call.
- D3 - List of contacts saved in the telephone.
For more information, refer to the "Contacts" menu.
- D4 - End the current call.
- D5 - Duration, name and number of the contact for the current call.
- D6 - "Switch call": change contact while retaining the current contact. "Conference call": accept the incoming call and communicate with more than one person.
- D7 - "Micro OFF": cut the microphone temporarily so that the contact does not hear your conversation with a passenger.
- D8 - "Privacy mode": transfer to your telephone for a private conversation or to leave the vehicle without ending the call.
- D9 - Quit this shortcut menu.

06 BLUETOOTH

PAIRING A BLUETOOTH TELEPHONE FIRST CONNECTION

- 1 Activate the telephone's Bluetooth function and ensure that it is "visible to all" (telephone configuration).



- 2 Press **MENU** to display the "**MAIN MENU**" then select "**Communications**".



- 3 Select "**Bluetooth**".



- 4 Select **Search**.
The list of peripherals detected is displayed.



- 5 Select the name of the desired peripheral from the list and **Confirm**.



- ! For reasons of safety and because they require prolonged attention on the part of the driver, the operations for pairing the Bluetooth mobile telephone to the hands-free system of the audio unit must be carried out with the **vehicle stationary**.

- 6 The system offers to connect the telephone:
- or "**All profiles**" (for selection of both profiles).
 - in "**Telephone (hands free)**" profile (telephone only),
 - in "**Streaming Audio**" profile (streaming: playing music files on the telephone),
- Select and confirm.

- ☀ The "**Hands-free**" profile should be used in preference if "Streaming" is not desired.

- ! The ability of the system to connect with only one profile depends on the telephone. The two profiles may both connect by default.

- ☀ Visit www.peugeot.co.uk for more information (compatibility, additional help, ...).

06 BLUETOOTH



The services available depend on the network, the SIM card and the compatibility of the Bluetooth telephone used. Check the telephone manual and with your network provider for details of the services available to you.

7

Choose a code for the connection then "**Confirm**".



8

Enter the same code on the telephone then accept the connection.



9

The telephone is added to the list.



10

Then accept automatic connection on the telephone to allow the telephone to reconnect automatically every time the vehicle is started.



Depending on the type of telephone, the system will ask you to accept or not the transfer of your contacts.

If not, select "**Update**".



On return to the vehicle, the last telephone connected automatically reconnects, within around 30 seconds after switching on the ignition (Bluetooth activated and visible).

To modify the automatic connection mode, remove the pairing and pair the telephone again with the desired mode.

06 BLUETOOTH

RECEIVING A CALL

1

An incoming call is announced by a ring and a superimposed display in the screen.

2a

Make a short press on the steering mounted **TEL** button to accept an incoming call.



2b

Make a long press on the steering mounted **TEL** button to reject the call.
or
Select "**End call**".



MANAGING PAIRED TELEPHONES

1

Press **MENU** to display the "**MAIN MENU**" then select "**Communications**".



2

Select "**Bluetooth**".



3

Select the name of the peripheral in the list.

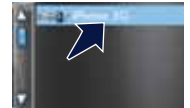

4

Select:

- "**Connect**" or "**Disconnect**" to connect or disconnect the Bluetooth connection with the peripheral selected.
- "**Delete**" to remove it from the list.

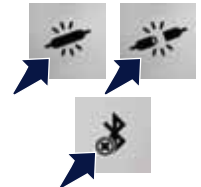

Select "**Settings**" for Bluetooth visibility, automatic call acceptance, importing contacts.



06 CONTACTS

MAKING A CALL

CALLING A NEW NUMBER

1 Press **MENU** to display the "MAIN MENU" then select "**Communications**".



2 Select "**Contacts**".





3 Select "**Keypad**".



4 Enter the phone number using the keypad then "**Call**" to start the call.



 **Shortcut:**
Press **MENU** to display the "MAIN MENU" then select the telephone.
Select or enter a number and then press "**Call**" to start the call.



Use of the telephone is not recommended while driving. We recommended that you park safely or make use of the steering mounted controls.

CALLING A CONTACT

1 Press **MENU** to display the "MAIN MENU" then select the telephone.



Or make a long press on the steering mounted **TEL** button.



2 Select "**Directory**".



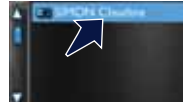

3 Select the desired contact from the list offered.



4 Select "**CALL**".



 Select the mobile or home line in the "**Info**" section.



06 CALL LOG

ENDING A CALL

CALLING A RECENTLY DIALLED NUMBER

1 Press **MENU** to display the "MAIN MENU" then select "**Communications**".



2 Select "**Call log**".



3 Select the desired contact from the list offered.

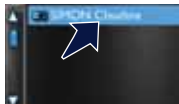

i It is always possible to make a call directly from the telephone; park the vehicle first as a safety measure.

1 Select the telephone in the screen.
or



Or make a long press on the steering mounted **TEL** button.
or



Press the **MODE** button until the **TELEPHONE** display is obtained.



2 Select "**End call**".



06 SETTINGS

RINGTONES

1 Press **MENU** to display the "MAIN MENU" then select "**Settings**".



2 Select "**Audio**".



3 Select "**Ringtones**".



4 You can select the ringtone used and adjust its volume.

5 Select "**Confirm**".



MANAGING CONTACTS / ENTRIES

1 Press Menu to display the "MAIN MENU" then select "**Communications**".



2 Select "**Contacts**".



3 Select "**Files**".



4 Select:

- "**New**" to add a new contact.
- "**Modify**" to edit the selected contact.
- "**Delete**" to delete the selected contact.
- "**Delete all**" to delete all of the information for the selected contact.

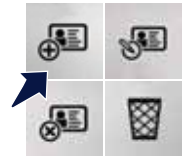

Select "**Directory status**" for the number of entries used, available, ...



07 SETTINGS

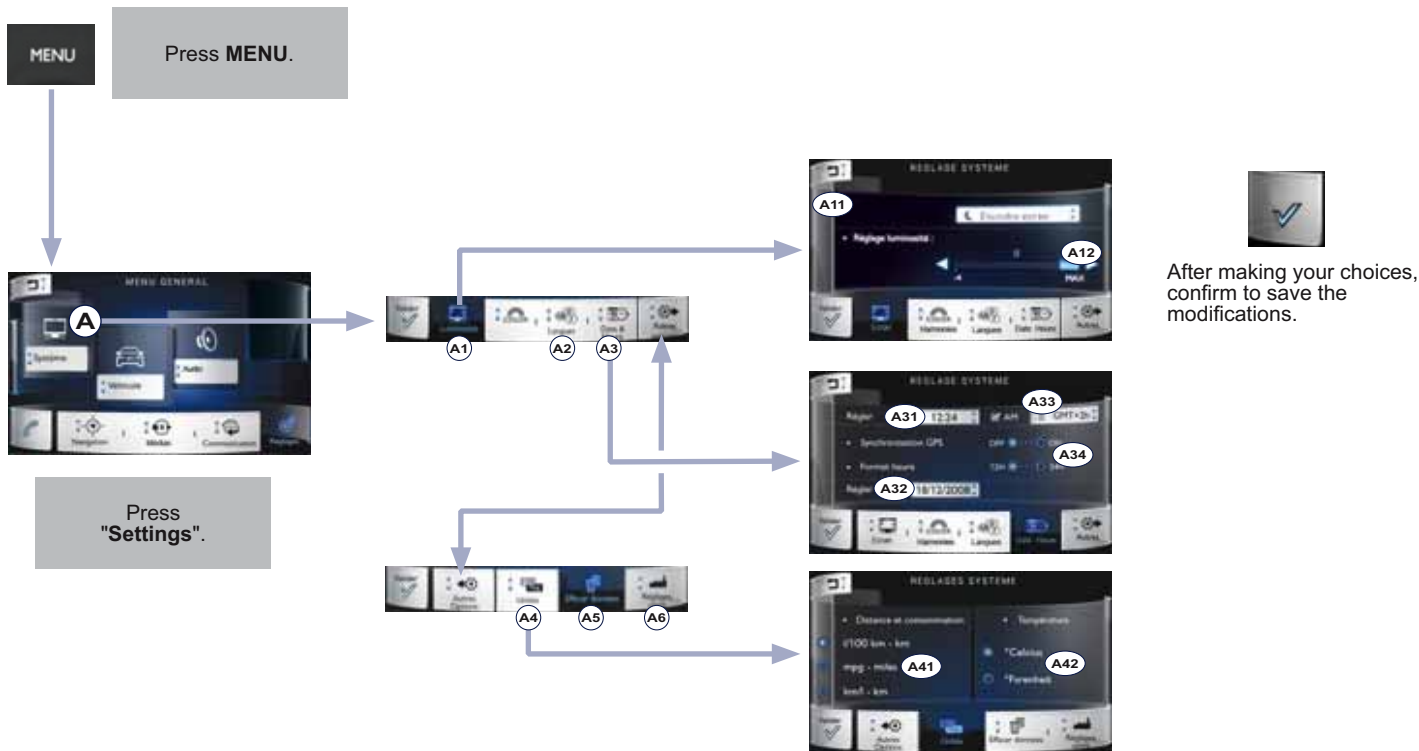



Access to the "Settings" menu

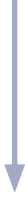

"System"

- A2 - Select the language then confirm.
- A5 - Select the data from the list then press "Delete".
- A6 - Restore original settings.

"Display"

- A1 - Brightness setting.
- A11 - Modify the screen brightness in daylight.
- A13 - Press to switch off the screen. Press the screen again (anywhere on its surface) to switch it on again.

"Date & Time"

- A3 - Setting the date and time.
- A31 - Adjust the time.
- A32 - Adjust the date.
- A33 - Adjust the time zone.
- A34 - Synchronise the time with GPS, change the time display format.

"Units"

- A4 - Setting units.
- A41 - Select the units used for the display of distance and fuel consumption.
- A42 - Select the units for the display of temperature.

07 SETTINGS





Access to the "Settings" menu (continued)

"Vehicle settings"

- B1 - Choose from the categories: "Driving assistance", "Vehicle access", "Lighting". If no family is chosen, the complete list of functions is displayed.
- B2 - Select the function, a descriptive text and image provides details of the function. The settings of some can be adjusted.
Select/deselect to activate/deactivate the function.



For more information on a setting, refer to the section on the corresponding function.

"Audio"

- C2 - Distribution: set the dominant position for sound in the vehicle making use of the Arkamys® system.
Move the point between the left (L) / right (R) and front (F) / rear (R).
- C3 - Choose the sound level when you touch the screen with a finger (keypad beep). Activate the sound level depending on vehicle speed.
- C4 - Choose the melody and the volume for the ringtone used for an incoming call.

"VEHICLE DIAGNOSTICS"

- B3 - List of faults detected (depending on version) in the vehicle.

"Speed memorised"

- B4 - Memorise speed settings for use by the cruise control or speed limiter.
- B41 - Choose a speed to see the details. Press again to select it.
- B42 - With the speed(s) selected, press "Activate speed" to memorise the speeds.
To deactivate all speeds, press "Activate speed".
- B43 - Select or deselect all speeds.
- B44 - Programme the speeds with default values.
- B45 - Modify the speed selected.

"Ambience"

- C1 - Choose the audio ambience (Jazz, Classic, Pop Rock, Techno, Vocal) or personalise the ambience with treble / bass and activate loudness.

"Ringtones"

- C5 - Choose the volume for the voice giving the names of streets.

07 SETTINGS

SYSTEM

MODIFY SYSTEM SETTINGS

1

Press **MENU** to display the "MAIN MENU" then select "**Settings**".



2

Select "**System**".



Select "**Other**" to display the other settings.



3

Select:

- "**Display**" to switch off the screen or adjust the brightness.
- "**Languages**" to change the language. A black screen is displayed after confirmation for a period of about 15 seconds.
- "**Units**" to change the units used for distance, fuel consumption and temperature.
- "**Date & Time**" to change the time zone, synchronisation with GPS, time and its format and then the date.



i

Select "**Del. data**" to delete the list of recent destinations, personal points of interest, contacts in the list.

Choose the item then select "**Del. data**".

Select "**Latest destinations**" then press on "**Del. data**" and confirm with the message.



Select "**Factory settings**" to return to the original settings.



07 SETTINGS

VEHICLE

MODIFY SETTINGS

1

Press **MENU** to display the "MAIN MENU" the select "**Settings**".



2

Select "**Vehicle**".



3

Choose the setting from the list to see its description and, depending on version, modify the setting.
Then select the setting to activate it.



4

Select "**Confirm**" to save the settings.



Select "**Driving**" and/or "**Access**" and/or "**Lighting**" to filter the categories.
Deselect all to have the complete list.



FREQUENTLY ASKED QUESTIONS

The following table groups together the answers to the most frequently asked questions concerning your audio system.

QUESTION	ANSWER	SOLUTION
The route calculation is not successful.	The guidance criteria may conflict with the current location (exclusion of toll roads on a toll motorway).	Check the guidance criteria on the Navigation Menu, "Guidance options" \ "Define calculation criteria".
The POIs do not appear.	The POIs have not been selected.	Select the POIs in the list of POIs.
	The POIs have not been downloaded.	Download the POIs from the website: " http://peugeot.navigation.com ".
The speed camera audible warning does not work.	The audible warning is not active.	Activate audible warnings in the Guidance options menu, "Navigation - guidance", "Set parameters for risk areas".
The system does not suggest a detour around an incident on the route.	The guidance criteria do not take account of TMC messages.	Select the "Traffic info" function in the list of guidance criteria.
I receive a speed camera alert for a speed camera which is not on my route.	Other than guidance, the system announces all speed cameras positioned in a cone located in front of the vehicle. It may provide an alert for speed cameras located on nearby or parallel roads.	Zoom in on the map to view the exact position of the speed camera. Select "On the route" to no longer receive alerts other than guidance or to reduce the time for the announcement.

FREQUENTLY ASKED QUESTIONS

QUESTION	ANSWER	SOLUTION
Certain traffic jams along the route are not indicated in real time.	On starting, it is several minutes before the system begins to receive the traffic information.	Wait until the traffic information is being received correctly (display of the traffic information icons on the map).
	The filters are too restrictive.	Modify the "Geographic filter" settings.
	In certain countries, only major routes (motorways...) are listed for the traffic information.	This phenomenon is normal. The system is dependent on the traffic information available.
The altitude is not displayed.	On starting, the initialisation of the GPS may take up to 3 minutes to receive more than 4 satellites correctly.	Wait until the system has started up completely. Check that there is a GPS coverage of at least 4 satellites (long press on the SETUP button, then select "GPS coverage").
	Depending on the geographical environment (tunnel...) or the weather, the conditions of reception of the GPS signal may vary.	This phenomenon is normal. The system is dependent on the GPS signal reception conditions.
I cannot connect my Bluetooth telephone.	The telephone's Bluetooth function may be switched off or the telephone may not be visible.	<ul style="list-style-type: none"> - Check that your telephone's Bluetooth function is switched on. - Check in the telephone settings that it is "visible to all".
	The Bluetooth telephone is not compatible with the system.	A list of compatible Bluetooth mobile telephones is available from the dealer network.
The volume of the telephone connected in Bluetooth mode is inaudible.	The volume depends both on the system and on the telephone.	Increase the volume of the audio system, to maximum if required, and increase the volume of the telephone if necessary.
	The ambient noise level has an influence on the quality of telephone communication.	Reduce the ambient noise level (close the windows, reduce the booster fan speed, slow down, ...).

FREQUENTLY ASKED QUESTIONS

QUESTION	ANSWER	SOLUTION
Some contacts are duplicated in the list.	The options for synchronizing contacts are synchronizing the contacts on the SIM card, the contacts on the telephone, or both. When both synchronizations are selected, some contacts may be duplicated.	Select "Display SIM card contacts" or "Display telephone contacts".
Contacts are not shown in alphabetical order.	Some telephones offer display options. Depending on the settings chosen, contacts can be transferred in a specific order.	Modify the display setting in the telephone directory.
The system does not receive SMS text messages.	The Bluetooth mode does not permit sending SMS text messages to the system.	
The CD is ejected automatically or is not played by the player.	<p>The CD is inserted upside down, is unplayable, does not contain any audio data or contains an audio format which the player cannot play.</p> <p>Le CD has been recorded in a format that is not compatible with the player.</p> <p>The CD is protected by an anti-pirating protection system which is not recognised by the audio system.</p>	<ul style="list-style-type: none"> - Check that the CD is inserted in the player the right way up. - Check the condition of the CD: the CD cannot be played if it is too damaged. - Check the content in the case of a recorded CD: consult the advice in the "Audio" section. - The audio system's CD player does not play DVDs. - Some recorded CDs will not be played by the audio system because they are not of the correct quality.
There is a long waiting period following the insertion of a CD or connection of a USB memory stick.	When a new medium is inserted, the system reads a certain amount of data (directory, title, artist, etc.). This may take from a few seconds to a few minutes.	This phenomenon is normal.
The CD player sound is poor.	The CD used is scratched or of poor quality.	Insert good quality CDs and store them in suitable conditions.
	The audio equipment settings (bass, treble, ambiances) are unsuitable.	Set the treble or bass level to 0, without selecting an ambience.

FREQUENTLY ASKED QUESTIONS

QUESTION	ANSWER	SOLUTION
Some characters in the media information are not displayed correctly while playing.	The audio system does not display some types of characters.	Use standard characters to name tracks and folders.
Playing of streaming files does not start.	The peripheral device connected does not support automatic play.	Start the playback from the device.
The names of tracks and the track length are not displayed on the screen when streaming audio.	The Bluetooth profile does not allow the transfer of this information.	
The quality of reception of the radio station listened to gradually deteriorates or the stored stations do not function (no sound, 87.5 Mhz is displayed...).	The vehicle is too far from the transmitter used by the station listened to or there is no transmitter in the geographical area through which the vehicle is travelling.	Activate the "RDS" function by means of the short-cut menu to enable the system to check whether there is a more powerful transmitter in the geographical area.
	The environment (hills, buildings, tunnels, basement car parks...) block reception, including in RDS mode.	This phenomenon is normal and does not indicate a fault with the audio system.
	The aerial is absent or has been damaged (for example when going through a car wash or into an underground car park).	Have the aerial checked by a PEUGEOT dealer.
I cannot find some radio stations in the list of stations received.	The station is not received or its name has changed in the list.	
	Some radio stations send other information in place of their name (the title of the song for example).	
The name of the radio station changes.	The system interprets this information as the name of the station.	

FREQUENTLY ASKED QUESTIONS

QUESTION	ANSWER	SOLUTION
In changing the setting of treble and bass the equalizer setting is deselected.	The selection of an equalizer setting imposes the balance settings. Modifying one without the other is not possible.	Modify the balance or equalizer settings to obtain the desired musical ambience.
In changing the equalizer setting, treble and bass return to zero.		
When changing the balance settings, the distribution setting is deselected.	The selection of a distribution setting imposes the balance settings. Modifying one without the other is not possible.	Modify the balance or distribution settings to obtain the desired musical ambience.
When changing an distribution setting, the balance setting is deselected.		
There is a difference in sound quality between the different audio sources (radio, CD...).	For optimum sound quality, the audio settings for Volume, Bass, Treble, Equalizer and Loudness can be adapted to the different sound sources, which may result in audible differences when changing source (radio, CD...).	Check that the audio settings for (Volume, Bass, Treble, Equalizer, Loudness) are adapted to the sources listened to. It is advisable to set the AUDIO functions (Bass, Treble, Fr-Re balance, Le-Ri balance) to the middle position, select the "None", musical ambience and set the loudness correction to the "Active" position in CD mode or to the "Inactive" position in radio mode.

FREQUENTLY ASKED QUESTIONS

QUESTION	ANSWER	SOLUTION
<p>With the engine off, the system switches off after a few minutes of use.</p>	<p>When the engine is switched off, the system's operating time depends on the battery charge. The switch-off is normal: the system switches to economy mode and switches off to prevent discharging of the vehicle's battery.</p>	<p>Start the vehicle's engine to increase the battery charge.</p>
<p>Playback of my USB memory stick starts only after a very long wait (around 2 to 3 minutes).</p>	<p>Some files supplied with the memory stick may greatly slow down access to reading the memory stick (multiplication by 10 of the catalogue time).</p>	<p>Delete the files supplied with the memory stick and limit the number of sub-folders in the file structure on the memory stick.</p>
<p>When I connect my iPhone as telephone and to the USB port at the same time, I am unable to play the music files.</p>	<p>When the iPhone connects automatically as a telephone, it forces the streaming function. The streaming function takes the place of the USB function which is then not useable, there is a period without sound of the track being played with Apple® players.</p>	<p>Disconnect and reconnect to the USB port (the USB function takes priority over streaming).</p>