



PEUGEOT

PEUGEOT **5008**

READY TO SET OFF

EXTERIOR

Directional lighting

This lighting automatically provides additional visibility when cornering.

Automatic guide me home lighting

Welcome lighting

This additional exterior and interior lighting, controlled remotely, makes your approach to the vehicle easier when the light is poor.

Visual and audible front and rear parking sensors

This system warns you if an obstacle is detected behind or in front of the vehicle in reverse or forward gear.

Parking space sensor

This system measures the size of the parking space available between two vehicles or obstacles.

Panoramic sunroof with electric blind

Temporary puncture repair kit

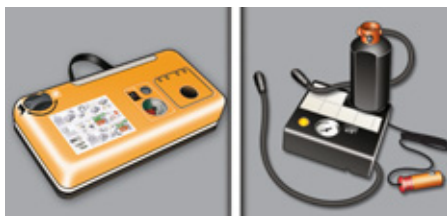

This kit, stowed in the boot under the concertina floor, is a complete system, consisting of a compressor and an integrated sealant product, for the temporary repair of a tyre.

Reversing camera

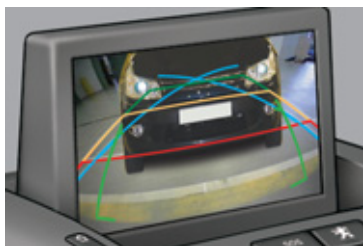

This system is activated automatically when engaging reverse, and provides an image in the colour screen.

Remote control key

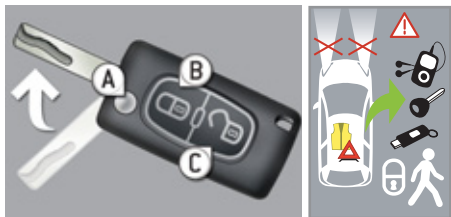

- A.** Unfolding / Folding the key.
- B.** Normal locking of the vehicle (press once).
Deadlocking of the vehicle (press twice).
- C.** Complete or selective unlocking of the vehicle.

Bonnet

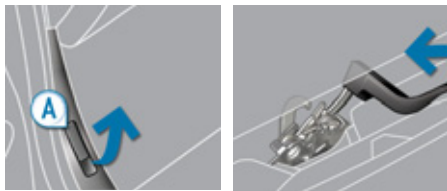

Opening

- ☞ Open the front left door.
- ☞ Pull the interior bonnet release lever **A**, located at the bottom of the door aperture.
- ☞ Push the exterior safety catch **B** to the left and raise the bonnet.
- ☞ Unclip the stay **C** from its housing.
- ☞ Fix the stay in the notch to hold the bonnet open.

Fuel tank

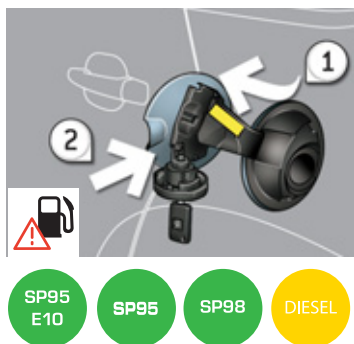

Fuel capacity: approximately 60 litres.

- 1.** Opening the filler flap.
- 2.** Removing and hooking the filler cap.



Closing

- ☞ Take the stay out of the support notch.
- ☞ Clip the stay in its housing.
- ☞ Lower the bonnet and release it at the end of its travel.
- ☞ Pull on the bonnet to check that it is secured correctly.

INTERIOR

Front seat adjustments

Head restraint adjustment

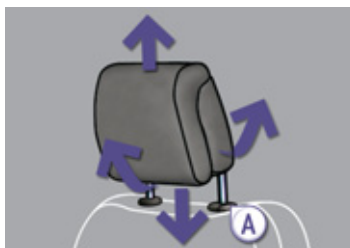

- ☞ To raise the head restraint, pull it forwards and upwards at the same time.
- ☞ To lower the head restraint, press the lug **A** and the head restraint at the same time.
- ☞ To adjust the angle of the head restraint, tilt its lower part forwards or rearwards.

Manual adjustments

Electric adjustments



Forward - backward



Height



Backrest angle

Steering wheel adjustment

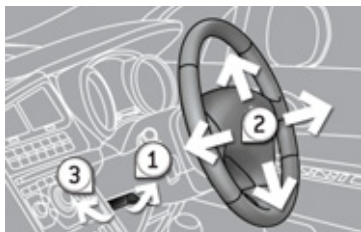

1. Release.
2. Adjust for height and reach.
3. Lock.

Front seat belts



Height adjustment

- ☞ To find a comfortable position, squeeze control **A** and slide it to the desired notch.

Rear view mirror

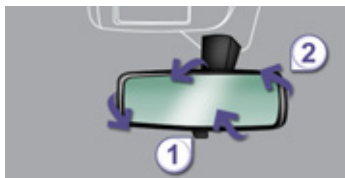

Manual day/night model

1. Selection of the "day" position of the mirror.
2. Adjustment of the mirror.

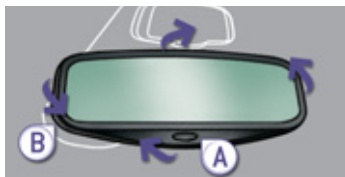

Automatic day/night model

- A.** Brightness detection in automatic day/night mode.
- B.** Adjustment of the mirror.

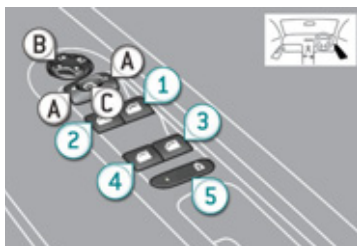

Door mirror adjustments

- A.** Selection of the mirror to adjust.
- B.** Adjustment of the mirror in four directions.
- C.** Folding / Unfolding.

Electric window controls

1. Driver's electric window.
2. Passenger's electric window.
3. Right hand rear electric window.
4. Left hand rear electric window.
5. Deactivation of the rear controls for the rear windows and, depending on version, for the rear doors (**electric child lock**).

Lighting controls

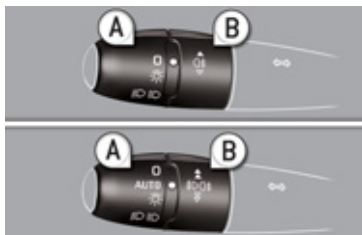

Ring A

- 0** Lighting off / daytime running lamps.
- AUTO** Automatic illumination of headlamps.
- Sidelamps.
- Dipped / main beam headlamps.

Ring B

- Rear foglamps only.
- Front and rear foglamps.

Wiper controls

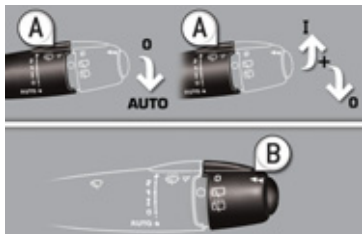

Stalk A: windscreen wipers

Switching on "AUTO"

☞ Press the stalk down and release it.

Switching off "AUTO"

☞ Push the stalk up and return it to position "0".

Ring B: rear wiper

- 0** Park.
- Intermittent wipe.
- Wash-wipe.

Manual air conditioning



1. Temperature adjustment.
2. Air flow adjustment.
3. Air distribution adjustment.
4. Air intake / air recirculation.
5. Air conditioning On / Off.

Dual-zone digital air conditioning



1. Automatic comfort programme
2. Temperature adjustment, driver's side.
3. Temperature adjustment, passenger's side.
4. Automatic demist/defrost programme.
5. Air conditioning On / Off.
6. Air distribution adjustment.
7. Air flow adjustment.
8. Air recirculation.
9. Mono-zone / Dual-zone.



Demisting - defrosting the rear screen

Panoramic sunroof

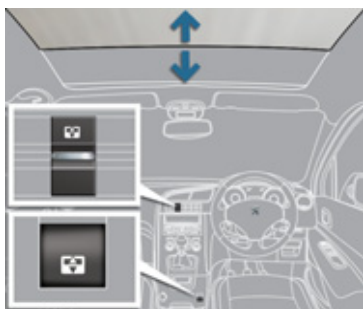

To open the blind:



To close the blind:



6-speed manual gearbox



Engaging 5th or 6th gear

- ☞ Move the lever fully to the right to engage 5th or 6th gear.



Engaging reverse gear

- ☞ Raise the ring under the knob and move the gear lever to the left then forwards.

6-speed electronic gearbox

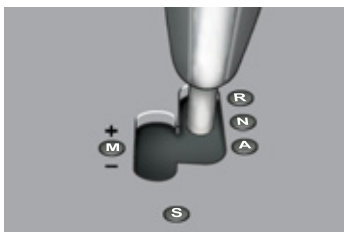

Gear lever

- R.** Reverse
- N.** Neutral.
- A.** Automatic mode.
- M. + / -** Manual mode with manual sequential changing of the gears.
- S.** Sport setting.

Steering mounted controls



- +** Change up paddle to the right of the steering wheel.
- ☞ Press the back of the "+" steering mounted paddle to change up a gear.
- Change down paddle to the left of the steering wheel.
- ☞ Press the back of the "-" steering mounted paddle to change down a gear.

! The steering mounted paddles cannot be used to select neutral or engage or disengage reverse gear.

Moving off

- ☞ Select position **N**.
- ☞ Press the brake pedal down fully.
- ☞ Start the engine.

N appears in the instrument panel screen.

- ☞ Keep your foot on the brake pedal, move the gear lever to position **A** or **M** to go forwards, or **R** to go backwards.

- ☞ Take your foot off the brake pedal, you can then move off.

- ☞ The parking brake is released automatically, otherwise release it manually.

Automatic gearbox



P. Park.

- Immobilisation of the vehicle, parking brake on or off.

- Starting the engine.

R. Reverse.

- Reversing manoeuvres, vehicle stationary, engine at idle.

N. Neutral.

- Immobilisation of the vehicle, parking brake on.
- Starting the engine.

D. Automatic operation.

M + / -. Manual operation with sequential changing of the six gears.

- ☞ Press forwards to change up through the gears.
- ☞ Press rearwards to change down through the gears.

Moving off



- ☞ With your foot on the brake, select position **P** or **N**.

- ☞ Start the engine.

If this procedure is not followed, there is an audible signal, accompanied by a message in the multifunction screen.

- ☞ With the engine running, press the brake pedal.
- ☞ Release the parking brake, unless it is programmed to automatic mode.
- ☞ Select position **R**, **D** or **M**,



- ☞ Gradually release the brake pedal. The vehicle moves off immediately.

Electric parking brake



Automatic release

The electric parking brake **releases automatically and progressively** when you press the accelerator :

- ☞ **Manual gearbox:** press down fully on the clutch pedal, engage first gear or reverse, press on the accelerator pedal and move off.
- ☞ **Electronic gearbox:** select position **A**, **M** or **R** then press on the accelerator pedal.
- ☞ **Automatic gearbox:** select position **D**, **M** or **R** then press on the accelerator pedal.

Full release of the parking brake is confirmed by :



- the parking brake applied warning lamp going off,



- the **P** warning lamp in the control lever **A** going off,

- display of the message "Parking brake off".

To immobilise the vehicle, engine running

With the engine running and the vehicle stationary, in order to immobilise the vehicle it is essential to **manually** apply the parking brake by **pulling** on control lever **A**.

The application of the parking brake is confirmed by :



- illumination of the parking brake applied warning lamp,



- illumination of the **P** warning lamp in the control lever **A**,

- display of the message "Parking brake on".

Automatic application, engine off

With the vehicle stationary, the parking brake **is automatically applied when the engine is switched off**.

An audible signal will confirm to you the application/ release of your electric parking brake.



When stationary, with the engine running, do not press the accelerator pedal unnecessarily, as you may release the parking brake.

Head-up display

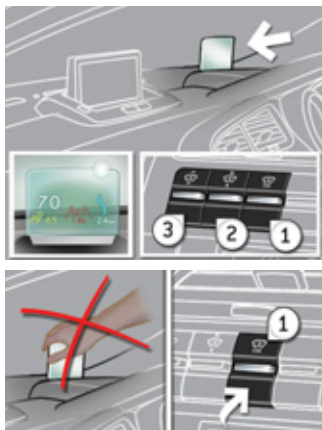

1. Head-up display on / off.
2. Brightness adjustment.
3. Display height adjustment.

Distance alert

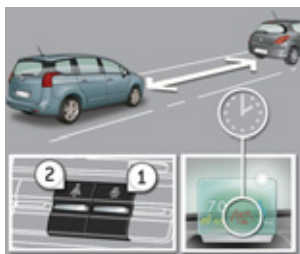

1. Distance alert on /off.
2. Alert value increase / decrease.

Stop & Start

Going into engine STOP mode

ECO The "ECO" warning lamp comes on in the instrument panel and the engine automatically goes into standby, **with an electronic gearbox** and at speeds below 4 mph (6 km/h), press the brake pedal or put the gear lever in position **N**.

In some circumstances, STOP mode may not be available; the "ECO" warning lamp flashes for few seconds, then goes off.

Going into engine START mode

ECO The "ECO" warning lamp goes off and the engine restarts automatically **with an electronic gearbox**:

- gear lever in position **A** or **M**, release the brake pedal,
- or gear lever in position **N** and the brake pedal released, move the gear lever to position **A** or **M**,
- or engage reverse.

In some circumstances START mode may be invoked automatically; the "ECO" warning lamp flashes for a few seconds, then goes off.

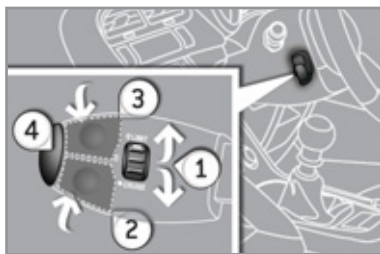

Cruise control "CRUISE"



1. Cruise control mode Selection / Off.
2. Programming a speed / Decreasing the programmed value.
3. Programming a speed / Increasing the programmed value.
4. Cruise control Off / Resume.

In order to be programmed or activated, the vehicle speed must be higher than 25 mph (40 km/h), with at least fourth gear engaged on the manual gearbox (second gear for an electronic or automatic gearbox).

Speed limiter "LIMIT"



1. Limiter mode Selection / Off.
2. Decreasing the programmed value.
3. Increasing the programmed value.
4. Speed limiter On / Off.

The values must be set with the engine running.

Arranging the boot

Roller load space cover



To remove the load space cover:

- ☞ remove the load space cover guides from the rails on the boot pillars,
- ☞ reel in the load space cover in its roller,



- ☞ pivot the ends of the roller upwards to release it,
- ☞ remove the roller from its support.

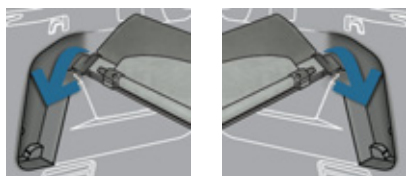

To store the load space cover, roller uppermost and flap facing towards the inside of the vehicle:

- ☞ place the right-hand end in its housing,
- ☞ slide the left-hand end into the guide then into its housing,

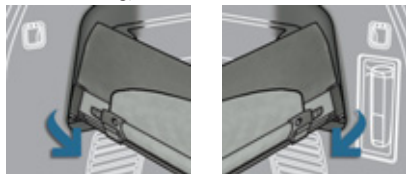

- ☞ secure the assembly by pivoting the ends downwards.



To install the load space cover:

- ☞ position one of the ends of the roller in its support,
- ☞ insert the second end in its support,
- ☞ pivot the ends of the roller downwards to secure it,
- ☞ reel out the load space cover to the boot pillars,
- ☞ insert the load space screen guides in the rails on the boot pillars.

If you use the 3rd row seats (7 seat version), it is essential to store the roller in its housing.

The roller has two rings for fixing the luggage retaining net depending on its location.

Arranging the seats

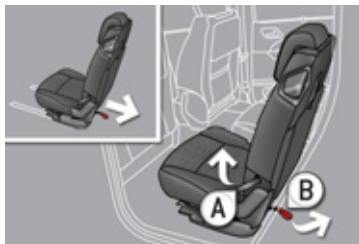

Folding the seats in the 2nd row

- ☞ Pull the strap **A** upwards firmly to release the seat and continue to pull until the seat is fully folded.

From the boot

- ☞ Pull the strap **B** to release the seat and push the seat back forwards gently.

Putting the seats back in place



- ☞ Raise the seat back and push it rearwards until it locks.

Rigid panel

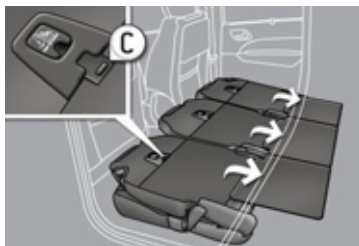

- ☞ After folding the seats, slide the catch **C**.

7 seat version

Access to the 3rd row seats



- ☞ Close the aircraft style tables on the 2nd row seats if they are open.
- ☞ Hold the control **D** up, the seat is released and the seat base rises to the seat back.
- ☞ Push the seat back forwards, holding the control **D** forwards.

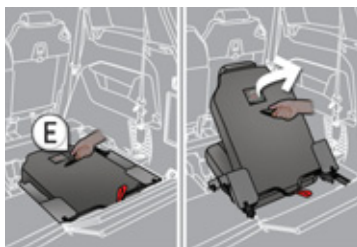

- ☞ Pull the strap **E** and guide the seat until the assembly locks.
- ☞ Fold the concertina boards forwards.

Changing from 5 to 7 seats

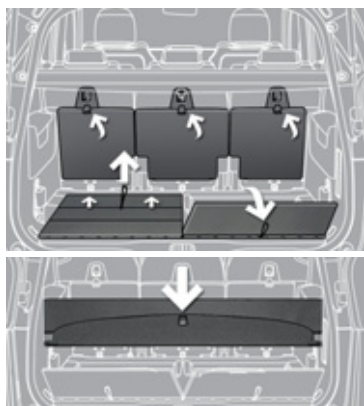

- ☞ Place the rigid panels of the 2nd row seats upright and lock them then fold the concertina boards rearwards.
- ☞ Remove the load space cover and store it in its housing.

Changing from 7 to 5 seats

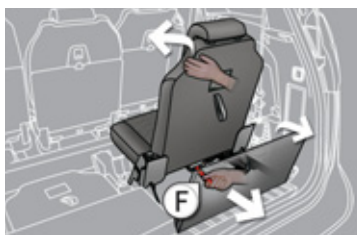

- ☞ Lower the head restraints and place the concertina board in the vertical position behind the seat.
- ☞ While pulling the strap **F**, push the seat back forwards gently.
- ☞ Remove the load space screen from its storage compartment and position it behind the 2nd row seats.

Deactivating the passenger's front airbag



- Insert the key into the passenger's front airbag deactivation switch.
- Turn it to the **"OFF"** position.
- Remove the key keeping the switch in the new position.



This warning lamp is on when the ignition is on and while the airbag is deactivated.

- To reactivate the airbag, turn the key to the **"ON"** position.

Electric child lock



Press this button to turn the child lock on.

Illumination of the indicator lamp in the button confirms that the lock is on.

Pairing a Bluetooth® telephone

With Peugeot Connect Navigation (RT6)

Quick procedure from the telephone



In the Bluetooth menu of your telephone, select the name "Peugeot" from the list of devices detected.



Enter a minimum 4 figure code in the telephone and confirm.



Enter the same code in the system, select **"OK"** and confirm.

With Peugeot Connect Sound (RD5)



Activate the telephone's Bluetooth function and ensure that it is "visible to all" (telephone configuration).



Press the **MENU** button.

In the menu, select :

- **"Perform a Bluetooth search"**

A window is displayed with a message that a search is in progress.

Select the telephone to be connected from the list. Only one telephone can be connected at a time.



A virtual keypad is displayed in the screen: enter a code with at least 4 digits.

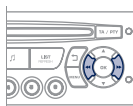

Confirm by pressing **OK**.

A message in the screen indicates the telephone chosen. To accept the pairing, enter the same code on the telephone, then confirm with **OK**.

A message that the pairing has been successful appears in the screen.

Peugeot Connect Navigation (RT6)

Selection and confirmation OK knob :

Selection of an item on the screen or in a list or a menu, then confirmation with a short press.

Other than for menus and lists, a short press displays a contextual menu depending on the current screen.

Rotation with map displayed: zoom the map scale in and out.

Short press without the engine running : on / off.

Short press with the engine running : audio source off / restore.

Volume adjustment.



Open the "Configuration" menu.

Select:

- the previous/next line in a list or menu.
- the previous / next media folder.
- step by step selection of the previous/next radio frequency.
- the previous / next MP3 folder.

Move up/down, in " **Move the map** " mode.

MODE button : Selection of the type of permanent display by pressing repeatedly (current radio station or media, navigation if in use, map, telephone if a call is in progress, trip computer).

Long press: black screen (DARK).

Access to the " **Navigation - guidance** " menu and display the recent destinations.

Open the " **Traffic information** " menu and display the current traffic alerts.

Abandon the current operation, up one level in the menu.
Long press : return to the permanent display.

Select:

- the next lower / higher radio frequency automatically.
- the previous / next CD track, MP3 track or media.
- the left / right of the screen when a menu is displayed.

Move left / right in " **Move the map** " mode.

Access to the " **RADIO** " menu and display the list of stations received.

Long press : display the audio settings screen for the radio tuner source.

Access to the " **MUSIC** " menu, and display of the CD/MP3/Apple® tracks and folders.

Long press : display the audio settings screen for the " **MEDIA** " (CD/USB/iPod/Streaming/AUX) sources.

Open the " **Telephone** " menu and display the list of recent calls or accept an incoming call.



Continuous press: reinitialisation of the system.

Short press : select pre-set radio station.

Long press : pre-set the current station.

Peugeot Connect Sound

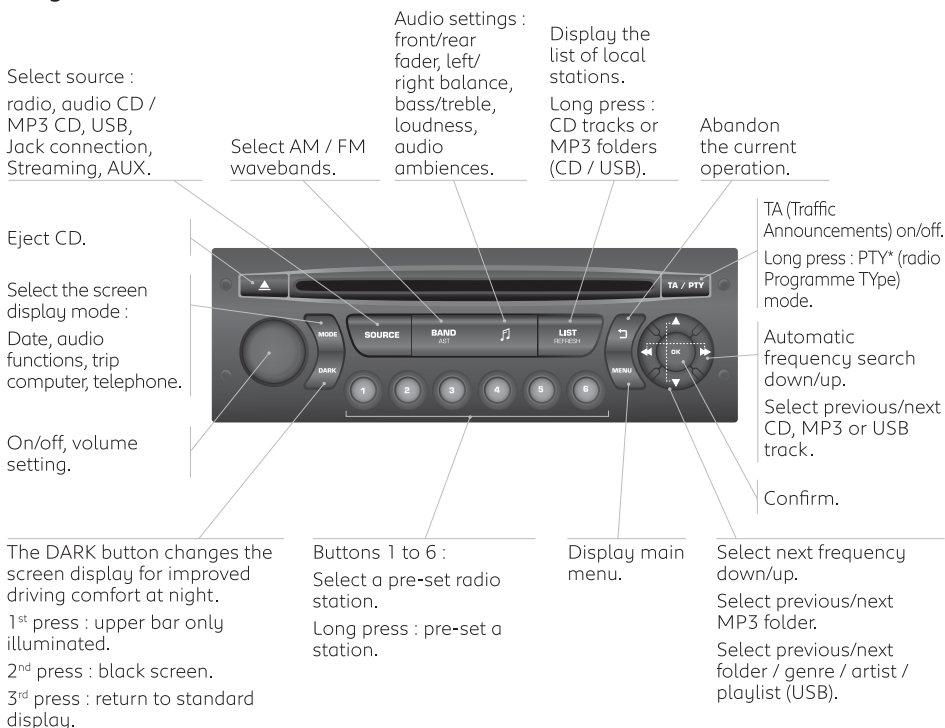

* Available according to version.

Emergency or assistance call

PEUGEOT CONNECT SOS



Peugeot Connect SOS

In an emergency, press this button for more than 2 seconds. Flashing of the green LED and a voice message confirm that the call has been made to the "Peugeot Connect SOS" centre*.

PEUGEOT CONNECT ASSISTANCE



Peugeot Connect Assistance

Press this button for more than 2 seconds to request assistance if the vehicle breaks down.
A voice message confirms that the call has been made**.

* Subject to the general conditions for the service available from dealers and to technological and technical limitations.

** Depending on the geographical cover of "Peugeot Connect SOS", "Peugeot Connect Assistance" and the official national language selected by the owner of the vehicle.

The list of countries covered and PEUGEOT CONNECT services services is available from dealers or at www.peugeot.co.uk.

Your vehicle will be fitted with only some of the equipment described in this document, depending on its trim level, version and the specification for the country in which it was sold.

This document is not a substitute for the detailed study of the handbook.

